

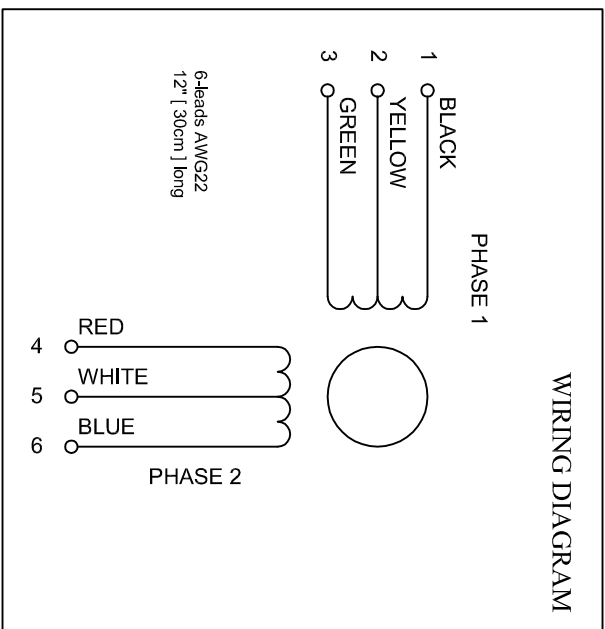

SPECIFICATIONS		(b)-unipolar connection (b)-bipolar series connection
Step Angle	deg	1.8
Voltage	V DC	4.5 (u), 6.3 (b)
Current / phase	A / phase	2.0 (u), 1.4 (b)
Resistance / phase	ohm / phase	2.25 (u), 4.5 (b)
Inductance / phase	mH / phase	3.6 (u), 14.4 (b)
Holding Torque	oz-in	190 (u), 240 (b)
	N-cm	135 (u), 170 (b)
Detent Torque	oz-in	N/A
	N-cm	N/A
Rotor Inertia	oz-in ²	2.6
	g-cm ²	475
Weight	lbs	2.25
	kg	1.0

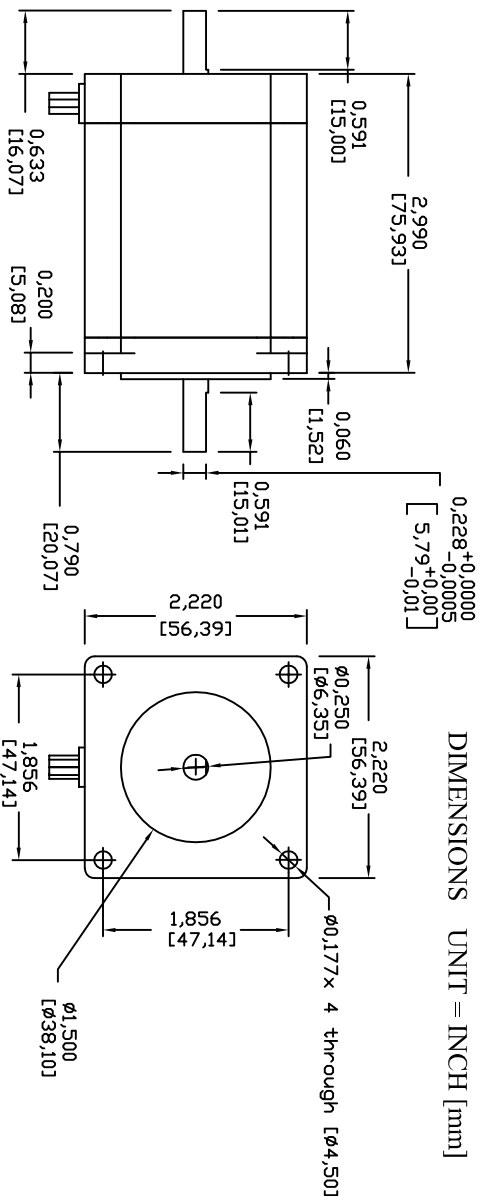
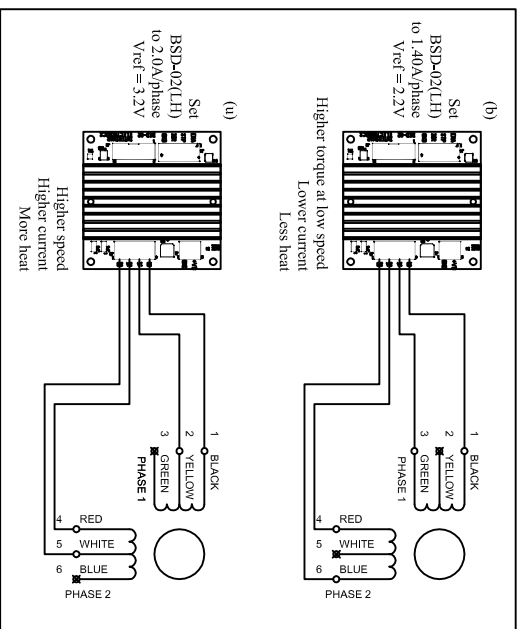

RECOMMENDED DRIVER:
 BSD-02 or BSD-02LH from Interinar Electronics
 - Vref Adjusted to 2.2V (1.4A/phase) for (b) or 3.2V (2.0A/phase) for (u)
 - Available step modes: Full-, Half-, Quarter- and Eighth- (or for LH Sixteenth-) Step
RECOMMENDED POWER SUPPLY:
 24Vdc, min 2.8A for (b) or 24Vdc, min 4.0A for (u)

We have used our best effort in preparing this document. We make no representations or warranties with respect to the accuracy or completeness of the contents of this document and specifically disclaim any implied warranties of fitness for a particular purpose. We shall not be liable for any loss of profit or any other commercial damages.			
REV	REV NDT	DATE	CAT
			59
http://www.interinar.com support@interinar.com		DWG#	FILE NAME
M.W. SCALE		P1121.09	PK268-02B
not to scale		DATE	SHEET
		11-21-2009	1

Interinar ELECTRONICS

TITLE: **2-PHASE STEP MOTOR**
 DWG#: **PK268-02B**