

DIMENSIONS (UNIT=INCH)

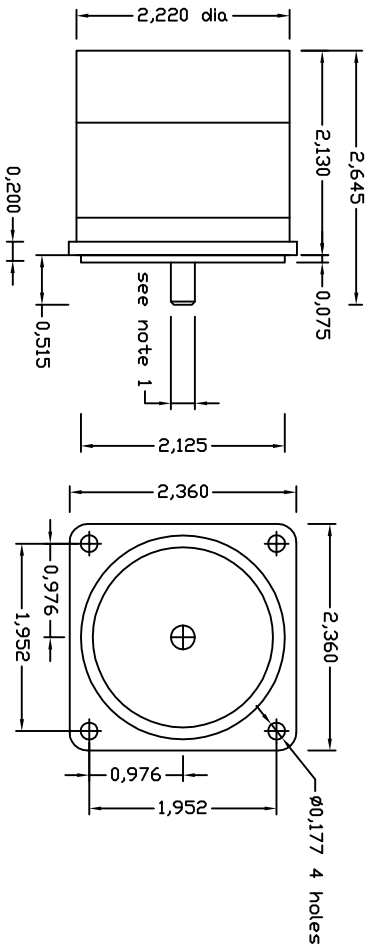

WIRING DIAGRAM

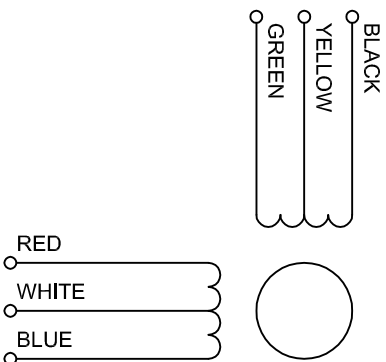

SPECIFICATIONS

Step Angle	deg	1.8
Voltage	V DC	6
Current / phase	A / phase	1.2
Holding Torque	oz-in	83.3
	N-cm	58.8
Resistance / phase	ohm / phase	5
Inductance / phase	mH / phase	8
Rotor Inertia	oz-in ²	0.74
	g-cm ²	135
Weight	lbs	1.3
	kg	0.6

NOTE 1:
 The PH266-01GK single shaft motor can be directly connected with Oriental Motor standard gearheads 2GKXKA. The shaft has 11 teeth with addendum diameter about 0.266" and dedendum diameter about 0.183". We were not able to find any exact manufacturing drawing to confirm our measurements.

We have used our best effort in preparing this document. We make no representations or warranties with respect to the accuracy or completeness of the contents of this document and specifically disclaim any implied warranties of fitness for a particular purpose. We shall not be liable for any loss of profit or any other commercial damages.

REV		REV NOTE		DATE		APV/D	
TITLE				PH266-01GK			
DWG#				C1002.06			
SCALE				1:2			
FILE NAME				PH266-01GK.dwg			
DATE				06-11-2006			
SHEET				1			
DF				1			