

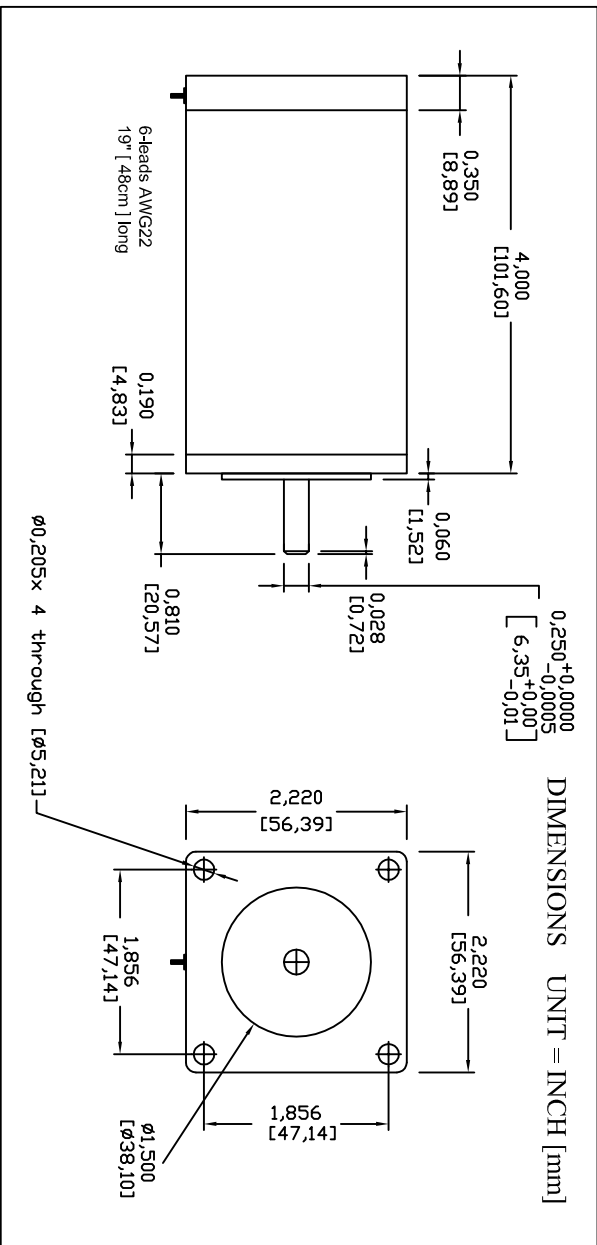

| SPECIFICATIONS | | (b)unipolar connection |
|--------------------|--------------------|------------------------|
| Step Angle | deg | 1.8 |
| Voltage | V DC | 2.2 (u), 3.1 (b) |
| Current / phase | A / phase | 4.6 (u), 3.25 (b) |
| Resistance / phase | ohm / phase | 0.4 (u), 1.1 (b) |
| Inductance / phase | mH / phase | 0.8 (u), 3.2 (b) |
| Holding Torque | oz-in | 150 (u), 212 (b) |
| | N-cm | 106 (u), 150 (b) |
| Detent Torque | oz-in | N/A |
| | N-cm | N/A |
| Rotor Inertia | oz-in ² | 1.76 |
| | g-cm ² | 322 |
| Weight | lbs | 2.8 |
| | kg | 1.3 |



RECOMMENDED DRIVER:
Unipolar or Bipolar driver with current 4.6A/phase for (u) unipolar connection or 3.25A/phase for (b)

RECOMMENDED POWER SUPPLY:
24Vdc, min 6.5A for (u) or min 4.5A for (b)

We have used our best effort in preparing this document. We make no representations or warranties with respect to the accuracy or completeness of the contents of this document and specifically disclaim any implied warranties of fitness for a particular purpose. We shall not be liable for any loss of profit or any other commercial damages.

| | | |
|-----|----------|------|
| REV | REV NOTE | DATE |
|-----|----------|------|

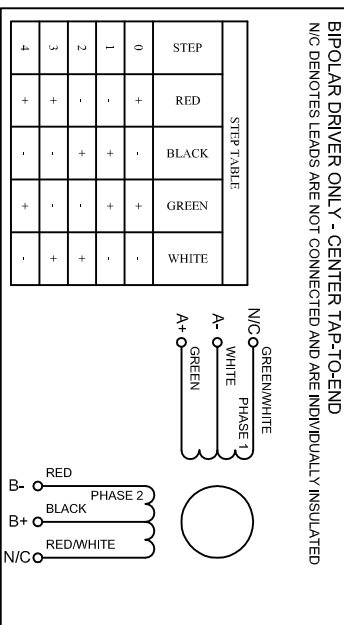
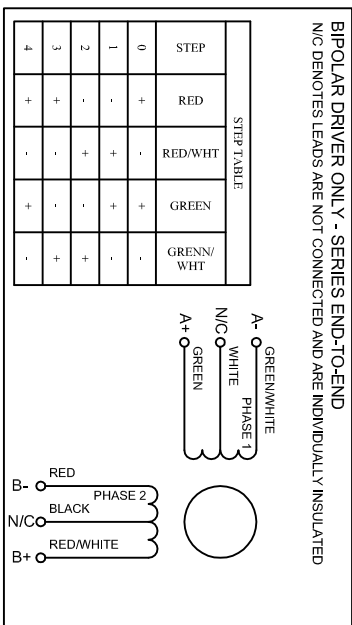
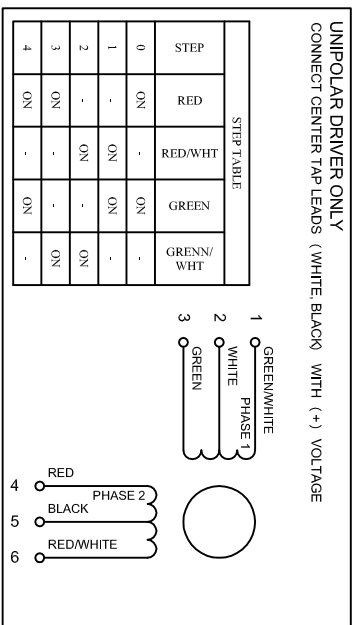

InterInnar ELECTRONICS

http://www.interinnar.com
support@interinnar.com

DWG M.W. SCALE not to scale CAT 58

TITLE 2-PHASE STEP MOTOR
4023-833 NEMA 23 -56mm

DWG# P1117.09

FILE NAME 4023-833.dwg

SHEET 1 OF 1

DATE 11-17-2009